



# FUEL SYSTEMS



How it works

## Fuel Saver

The STEINBAUER Fuel saver modifies the injection system by fine tuning the duration of the injectors. This is achieved by blue printing the original characteristics and intercepting the electronic signals from the ECU to the injection system. The fuel injection and engine speed are recorded and recalculated to optimize performance.

Installation

## CAT 220126

- 1 Disconnect the plug-in connection for the injection valve. It is situated at the left side (in direction of motion) of the engine block.
- 2 Plug in the connectors of the STEINBAUER wiring loom and lock them.
- 3 Connect the red wire on alternator Positive (+) terminal and black wire on chassis MINUS (-).

**\*REMEMBER TO DISCONNECT BATTERY CABLES\***

View:

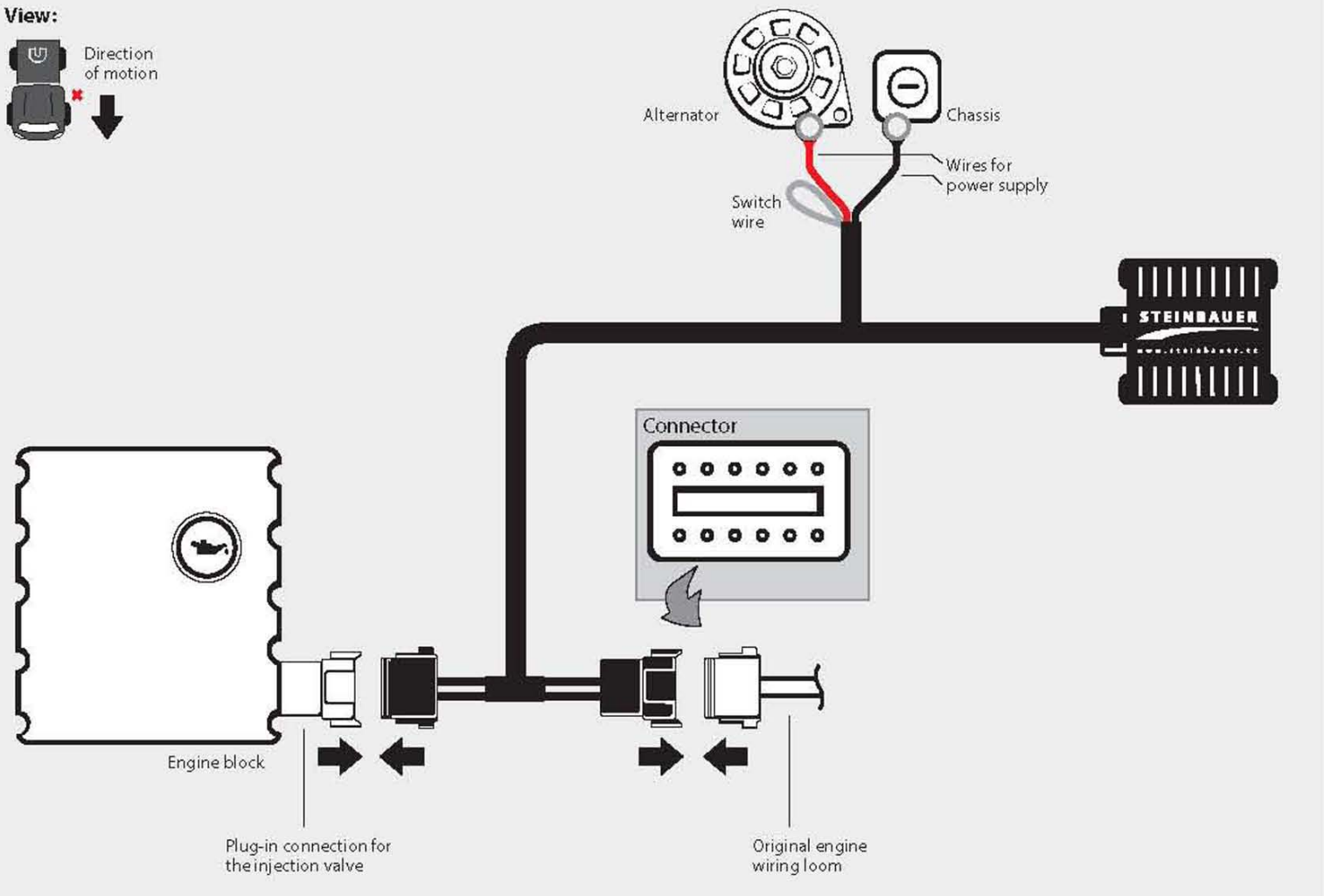

**Area Diesel Service, Inc.**

**WWW.AREADIESEL.COM**

Illinois: [800]637-2658 Iowa: [800]237-4692

ADS2008-015